

PROP. SITE PRES.
NO. - 188/2 PRINCE
ANWAR SHAH ROAD

6.096 M (20'-0") WIDE RECORDED ROAD BUT
PHYSICALLY 5.639 M (18'-6") WIDE AT SITE.
THIS PREMISES IS NOT RESPONSIBLE
FOR THIS ENCROACHMENT.

LOCATION MAP WITH LATITUDE AND LONGITUDE FOR THE
PROJECT NAMED "188/2" at 188/2, Prince Anwar Shah Road,
Kolkata - 700045, PO & PS - Lake Gardens, under Ward No. 93 of
Borough - X of KMC, WB, India

Latitude : 22°30'12.1392"N
Longitude : 88°21'30.45996"E

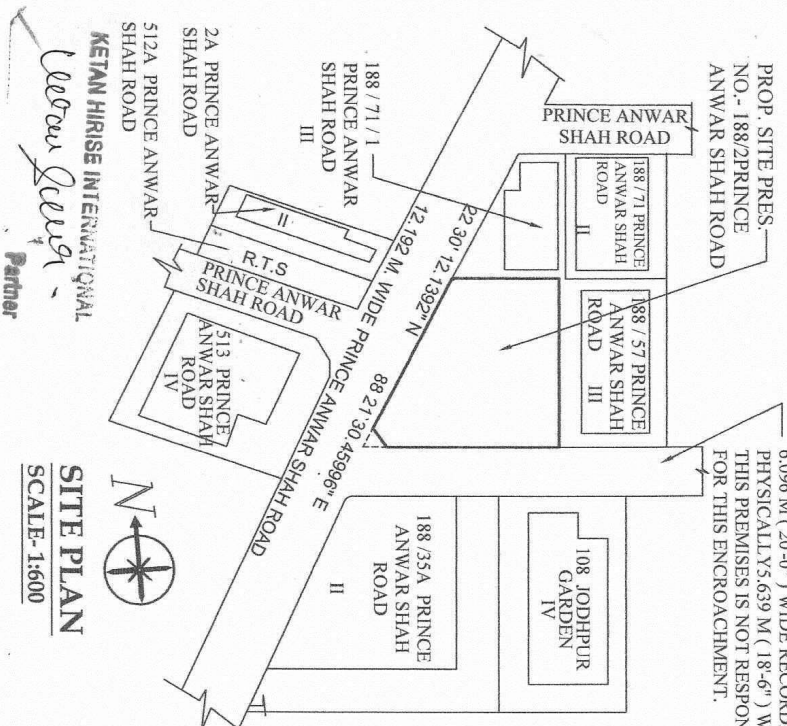

SITE PLAN
SCALE-1:600

Keenan Hirse
Partner
KETAN HIRSE INTERNATIONAL

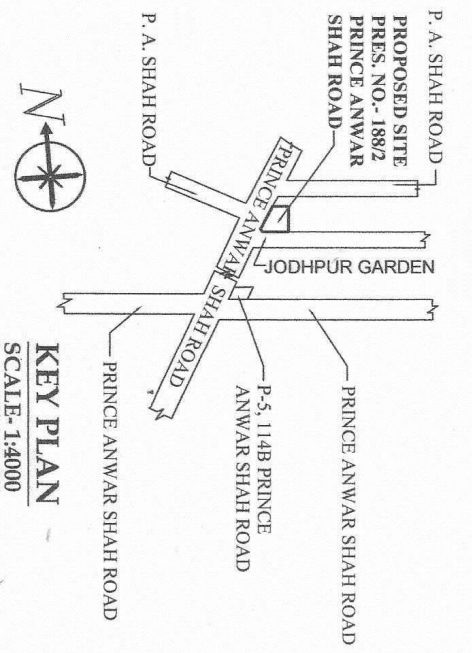

KEY PLAN
SCALE-1:4000

L.B.S.
Babul Chaudhury
B.E. (CIVIL), M.L.E., M.A.S.C.E. (IND.), M.I. Struct. E.
(IND.), Valuer, M.I.S.E., Chartered Engineer,
L.B.S. Class I & Empenned Structural Engineer,
Calcutta Municipal Corporation
LBS-741(1) & ESE-1/03
138B, Meghna Sena Sarani
Kolkata - 700 029

SIGNATURE OF L.B.S.

**SITE PLAN OF PREMISES NO.-188/2, PRINCE ANWAR SHAH ROAD WARD NO.- 93
BOROUGH - X, UNDER K.M.C. P.S.- JADAVPUR, KOLKATA - 700 033.**